

Introduction

ACO Modular Channel product range

The ACO Modular Channel portfolio includes channels for all common applications and all common floor types (concrete, tile or resin). Selecting a channel from the range is easy. The unique variability of the whole product range makes it easy to choose the right channel according to a specific customer's needs.

The channel's length, depth and outlet position are just a few of the parameters which can be specified.

ACO Modular Channel ordering

The dimensions of the ACO Modular Channel can be easily specified in respect of project requirements.

ACO Modular Channel customization

In addition, all ACO Modular Channels can be designed to a special length.

To request a custom ACO Modular Channel, please contact our Sales/ Technical department.

ACO Modular Channel system overview

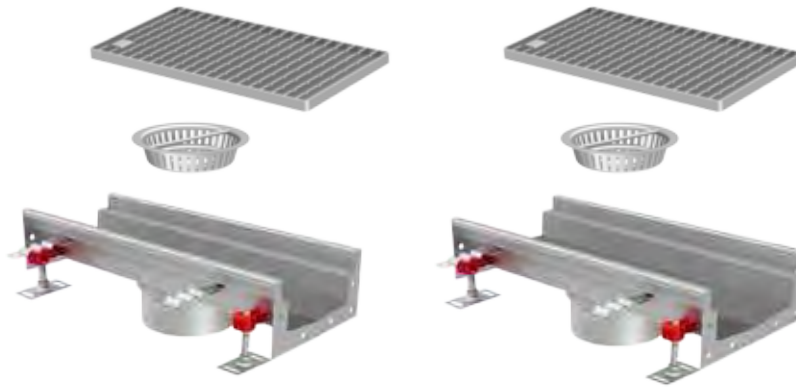

ACO Modular 125

ACO Modular 200



**All ACO Modular Channel
systems can be used in
conjunction with ACO
Floor Drain bodies and
accessories**

ACO Modular system overview



1 Outlet unit (pg 98)

2 Neutral invert and sloping sections (pg 95, 96)

3 Corner unit (pg 96)

4 Branch unit (pg 97)

5 Grate (pg 101)

6 Floor Drain body (pg 15)

7 Silt basket (pg 104)

ACO Modular 125 - standard products

Product information

The modular concept allows for the specification of standard channel units to suit a variety of custom layouts.

The Vee-bottomed (V) profiled channel offers enhanced flow efficiency at low flow rates and improved self cleaning performance.

- Fully tested and classified to EN 1433
- Available in AISI 304 (304) or AISI 316L (316L) grades of stainless steel
- Fully pickle passivated finish
- Easy and secure adjustable connection with floor drain
- Cut on demand products available to minimize work on site
- Wide range of grates available certified to EN1433 - standard grates up to C 250; custom grates up to E 600
- Special duty grates available on request

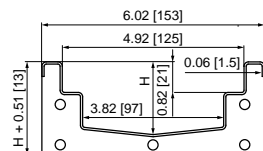

Neutral invert channel

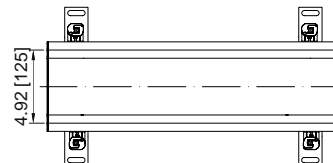
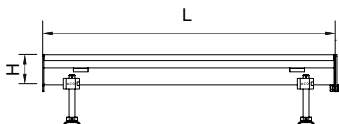

L in [mm]	Dimensions		Part number	
	H in [mm]	AISI 304	AISI 316L	
19.69 [500]	1.97 [50]	105119	407211	
	2.56 [65]	105120	407212	
	3.15 [80]	105121	407213	
	3.74 [95]	105122	407214	
	4.33 [110]	105123	407215	
	4.92 [125]	105124	407216	
39.37 [1000]	1.97 [50]	105127	407217	
	2.56 [65]	105128	407218	
	3.15 [80]	105129	407219	
	3.74 [95]	105130	407220	
	4.33 [110]	105131	407221	
	4.92 [125]	105132	407222	
78.74 [2000]	1.97 [50]	105135	407223	
	2.56 [65]	105136	407224	
	3.15 [80]	105137	407225	
	3.74 [95]	105138	407226	
	4.33 [110]	105139	407227	
	4.92 [125]	105140	407228	
118.11 [3000]	1.97 [50]	105143	407229	
	2.56 [65]	105144	407230	
	3.15 [80]	105145	407231	
	3.74 [95]	105146	407232	
	4.33 [110]	105147	407233	
	4.92 [125]	105148	407234	

Note: Items are equipped with seal and connecting hardware on one end.

Sloping invert channels

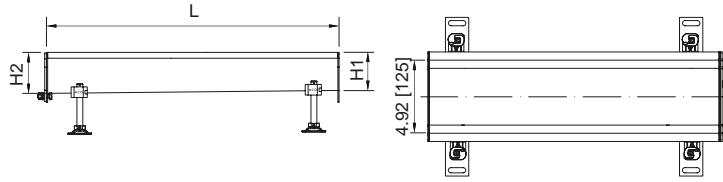

L in [mm]	Dimensions		Part number	
	H1 in [mm]	H2 in [mm]	AISI 304	AISI 316L
19.69 [500]	1.97 [50]	2.56 [65]	105151	407235
	2.56 [65]	3.15 [80]	105152	407236
39.37 [1000]	1.97 [50]	2.56 [65]	105155	407237
	2.56 [65]	3.15 [80]	105156	407238
	3.15 [80]	3.74 [95]	105157	407239
	3.74 [95]	4.33 [110]	105158	407240
78.74 [2000]	1.97 [50]	2.56 [65]	105161	407241
	2.56 [65]	3.15 [80]	105162	407242
	3.15 [80]	3.74 [95]	105163	407243
	3.74 [95]	4.33 [110]	105164	407244
	4.33 [110]	4.92 [125]	105165	407245
118.11 [3000]	1.97 [50]	2.56 [65]	105168	407246
	2.56 [65]	3.15 [80]	105169	407247
	3.15 [80]	3.74 [95]	105170	407248
	3.74 [95]	4.33 [110]	105171	407249
	4.33 [110]	4.92 [125]	105172	407250

Note: Items are equipped with seal and connecting hardware on deeper end.

Corner unit

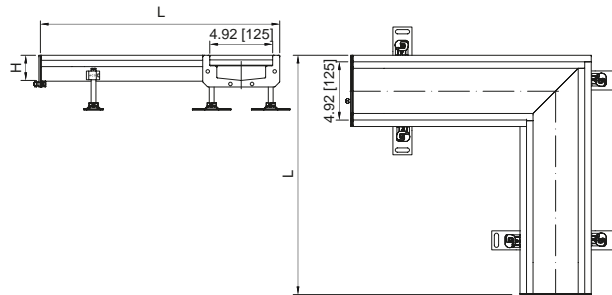

L in [mm]	Dimensions		Part number	
	H	H	AISI 304	AISI 316L
20.28 [515]	1.97 [50]	2.56 [65]	409812	409818
	2.56 [65]	3.15 [80]	409813	409819
	3.15 [80]	3.74 [95]	409814	409820
	3.74 [95]	4.33 [110]	409815	409821
	4.33 [110]	4.92 [125]	409816	409822
	4.92 [125]	4.92 [125]	409817	409823

Note: Items are equipped with seal and connecting hardware on one end.

Branch unit

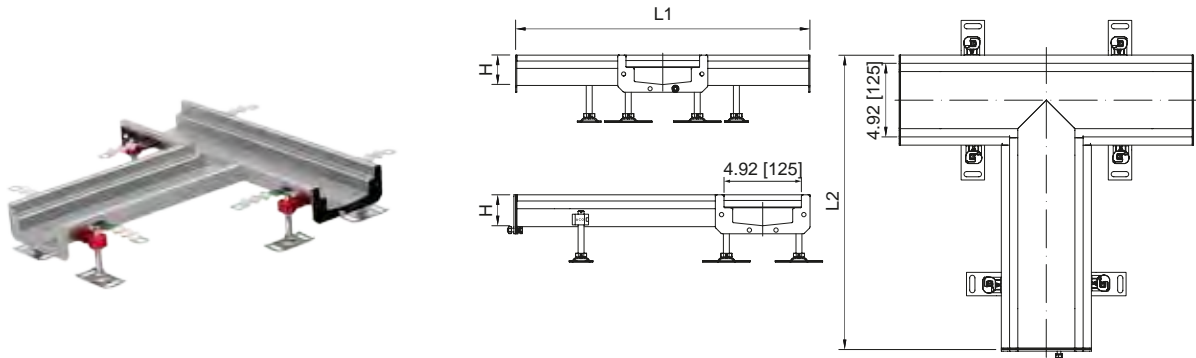

L1 in [mm]	Dimensions		Part number	
	L2 in [mm]	H in [mm]	AISI 304	AISI 316L
19.69 [500]	20.28 [515]	1.97 [50]	409824	409830
		2.56 [65]	409825	409831
		3.15 [80]	409826	409832
		3.74 [95]	409827	409833
		4.33 [110]	409828	409834
		4.92 [125]	409829	409835

Note: Items are equipped with seal and connecting hardware on one end.

End outlet

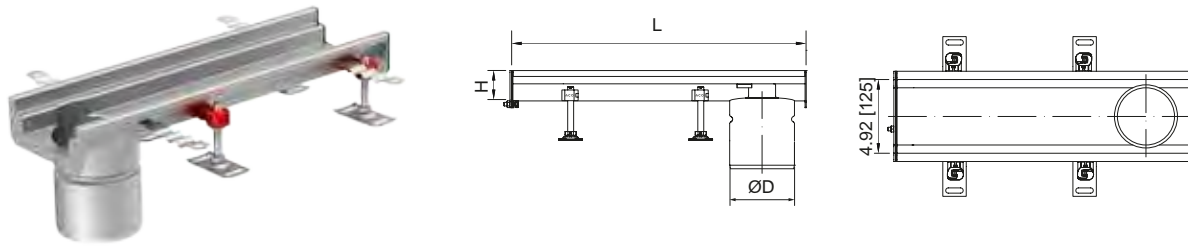

Dimensions		Floor drain	Outlet diameter ØD in [mm]	Part number	
L in [mm]	H in [mm]			AISI 304	AISI 316L
19.69 [500]	1.97 [50]	ACO 8" Hygienic Floor Drain	4.92 [125]	415946	415991
	2.56 [65]			415947	415992
	3.15 [80]			415948	415993
	3.74 [95]			415949	415994
	4.33 [110]			415950	415995
	4.92 [125]			415951	415996
	1.97 [50]	ACO 10" Hygienic Floor Drain	5.59 [142]	409732	409733
	2.56 [65]			409736	409737
	3.15 [80]			409740	409741
	3.74 [95]			409744	409745
	4.33 [110]			409724	409725
	4.92 [125]			409728	409729
	3.15 [80]		4" Sch 10	445401	445409
	3.74 [95]			445402	445410
	4.33 [110]			445403	445411
4.92 [125]	445404			445412	

Note: Items are without seal and connecting hardware.

Center outlet

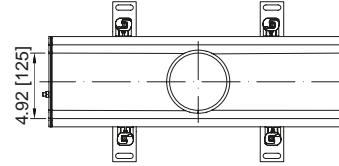
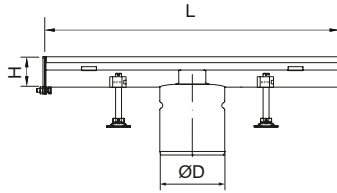

Dimensions		Floor drain	Outlet diameter ØD in [mm]	Part number	
L in [mm]	H in [mm]			AISI 304	AISI 316L
19.69 [500]	1.97 [50]	ACO 8" Hygienic Floor Drain	4.92 [125]	415958	416003
	2.56 [65]			415959	416004
	3.15 [80]			415960	416005
	3.74 [95]			415961	416006
	4.33 [110]			415962	416007
	4.92 [125]			415963	416008
	1.97 [50]	ACO 10" Hygienic Floor Drain	5.59 [142]	409734	409735
	2.56 [65]			409738	409739
	3.15 [80]			409742	409743
	3.74 [95]			409746	409747
	4.33 [110]			409726	409727
	4.92 [125]			409730	409731
	3.15 [80]	4" Sch 10		445405	445413
	3.74 [95]			445406	445414
	4.33 [110]			445407	445415
4.92 [125]	445408			445416	

Note: Items are without seal and connecting hardware.

End plate

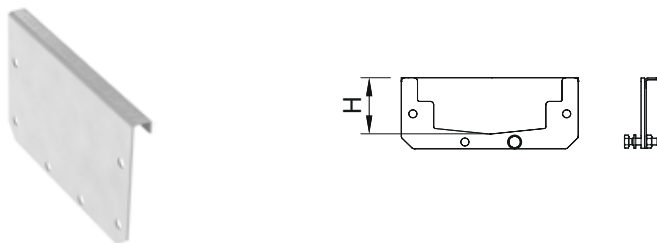

Dimensions H in [mm]	Part number	
	AISI 304	AISI 316L
1.97 [50]	105100	407196
2.56 [65]	105101	407197
3.15 [80]	105102	407198
3.74 [95]	105103	407199
4.33 [110]	105104	407200
4.92 [125]	105105	407201

Note: Items are equipped with seal and connecting hardware.

End plate with 2" [50 mm] outlet

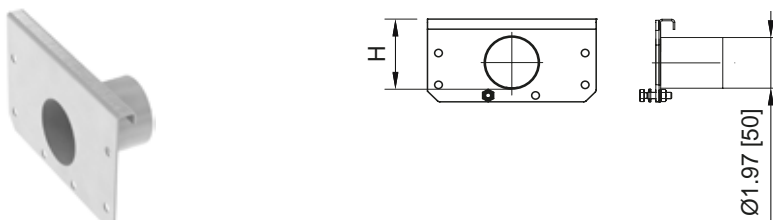

Dimensions H in [mm]	Part number	
	AISI 304	AISI 316L
3.74 [95]	409116	409121
4.33 [110]	409117	409122
4.92 [125]	409118	409123

Note: Items are equipped with seal and connecting hardware.

Rubber gasket



Dimensions H in [mm]	Material	Part number
1.97 [50]	NBR acrylonitrile butadiene rubber	413587
2.56 [65]		413588
3.15 [80]		413589
3.74 [95]		413590
4.33 [110]		413591
4.92 [125]		413592

Note: Items include seal and connecting hardware.

Grates for ACO Modular 125

Product information

- Fully tested and classified to EN 1433
- Available in AISI 304 or AISI 316L grades of stainless steel
- Special length of 14.76" [375 mm] for branches and corner units
- Load classes A 15, B 125 and C 250
- Custom grate options available up to load class E 600

ACO Mesh Grate

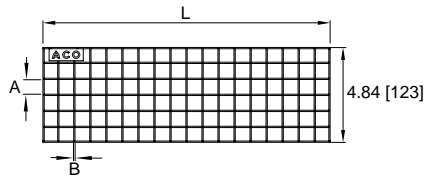

Length L in [mm]	Load class	Slip resistant	Slot size in [mm]		Material	Part number	
			A	B			
14.76 [375]	A 15	Yes	0.91 [23]	0.08 [2]	AISI 304	414130	
					AISI 316L	414180	
19.69 [500]					AISI 304	21710	
					AISI 316L	21715	
39.37 [1000]					AISI 304	21610	
	AISI 316L		21615				
14.76 [375]	C 250			0.91 [23]	0.12 [3]	AISI 304	414131
						AISI 316L	414181
19.69 [500]				0.87 [22]	0.12 [3]	AISI 304	21910
						AISI 316L	21915
39.37 [1000]		AISI 304				21810	
		AISI 316L				21815	

ACO Heelsafe Grate

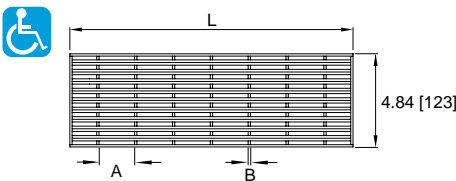

Length L in [mm]	Load class	Slip resistant	Slot size in [mm]		Material	Part number
			A	B		
14.76 [375]	B 125	No	1.85 [47]	0.12 [3]	AISI 304	414135
					AISI 316L	414185
19.69 [500]					AISI 304	96819
					AISI 316L	401238
39.37 [1000]					AISI 304	96818
	AISI 316L	401237				

ACO Multi-slot 5 Grate

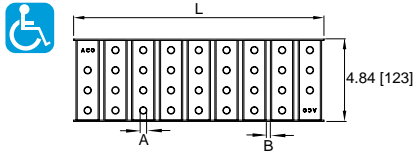

Length L in [mm]	Load class	Slip resistant	Slot size in [mm]		Material	Part number
			A	B		
14.76 [375]	A 15	Yes	0.26 [6.5]	0.24 [6]	AISI 304	414139
19.69 [500]					AISI 316L	414189
39.37 [1000]					AISI 304	409290
19.69 [500]	AISI 316L		409291			
39.37 [1000]	B 125		AISI 304		409286	
			AISI 316L		409287	
		AISI 304	409294			
19.69 [500]	B 125	0.26 [6.5]	0.24 [6]	AISI 316L	409295	
39.37 [1000]		0.20 [5]		AISI 304	409236	
		0.20 [5]		AISI 316L	409237	

ACO Quadrato Grate

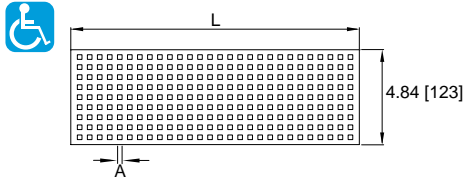

Length L in [mm]	Load class	Slip resistant	Slot size in [mm]		Material	Part number
			A			
14.76 [375]	A 15	No	0.24 [6]		AISI 304	414138
19.69 [500]					AISI 316L	414188
39.37 [1000]					AISI 304	105528
	AISI 316L				407925	
	AISI 304				105527	
	AISI 316L				407924	

ACO Plastic Grate

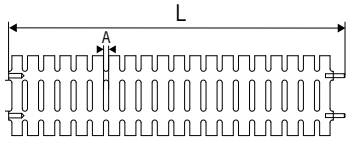

Length L in [mm]	Load class	Slip resistant	Slot size in [mm]	Material	Part number
			A		
19.69 [500]	A 15	No	0.31 [8]	-	21790
39.37 [1000]				-	21690

ACO Hygienic Ladder Grate

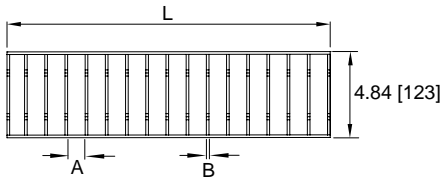

Length L in [mm]	Load class	Slip resistant	Slot size in [mm]		Material	Part number
			A	B		
14.76 [375]	C 250	Yes	0.79 [20]	0.2 [5]	AISI 304	414134
					AISI 316L	414184
19.69 [500]					AISI 304	21740
					AISI 316L	21745
39.37 [1000]					AISI 304	21741
					AISI 316L	21746

Accessories for ACO Modular 125

	Description	Used with	Material	Part number
	Silt basket ■ Stainless steel	ACO Modular 125 with 125mm outlet	AISI 304	414339
			AISI 316L	414340
		ACO Modular 125 with 142mm outlet	AISI 304	445149
			AISI 316L	445150

ACO Modular 200 - standard products

Product information

The modular concept allows for the specification of standard channel units to suit a variety of custom layouts.

The Vee-bottomed (V) profiled channel offers enhanced flow efficiency at low flow rates and improved self cleaning performance.

- Fully tested and classified to EN 1433
- Available in AISI 304 or AISI 316L grades of stainless steel
- Fully pickle passivated finish
- Easy and secure adjustable connection with floor drain
- Cut on demand products available to minimize work on site
- Wide range of grates for load class up to C 250 (EN 1433)
- Custom grate options available up to load class E 600

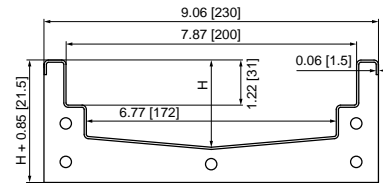

Neutral invert channel

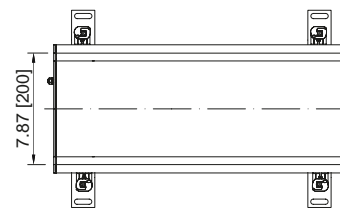

L in [mm]	Dimensions		Part number	
	H in [mm]		AISI 304	AISI 316L
19.69 [500]	2.36 [60]		409072	409050
	2.76 [70]		409047	409051
	3.15 [80]		409048	409052
	3.94 [100]		409049	409053
39.37 [1000]	2.36 [60]		401859	401860
	2.76 [70]		409054	409057
	3.15 [80]		409055	409058
	3.94 [100]		409056	409059
78.74 [2000]	2.36 [60]		401875	401876
	2.76 [70]		409060	409063
	3.15 [80]		409061	409064
	3.94 [100]		409062	409065
118.11 [3000]	2.36 [60]		401895	401896
	2.76 [70]		409066	409069
	3.15 [80]		409067	409070
	3.94 [100]		409068	409071

Note: Items are equipped with seal and connecting hardware for one end.

Sloping invert channels

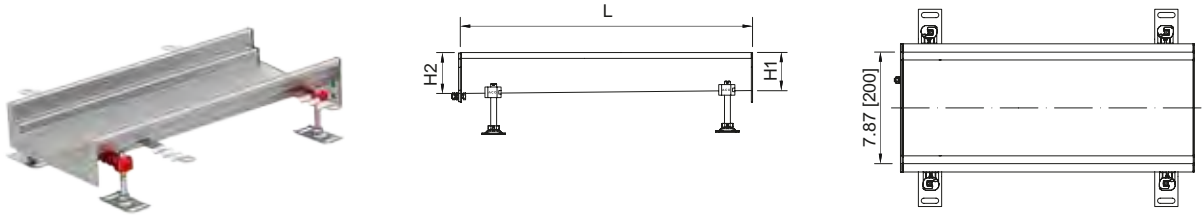

L in [mm]	Dimensions		Part number	
	H1 in [mm]	H2 in [mm]	AISI 304	AISI 316L
19.69 [500]	2.17 [55]	2.36 [60]	401855	401856
39.37 [1000]	2.36 [60]	2.76 [70]	401871	401872
	2.76 [70]	3.15 [80]	402464	402465
	3.15 [80]	3.54 [90]	402466	402467
	3.54 [90]	3.94 [100]	402468	402469
	3.94 [100]	4.33 [110]	402470	402471
78.74 [2000]	2.36 [60]	2.76 [70]	401887	401888
	2.76 [70]	3.15 [80]	402472	402473
	3.15 [80]	3.54 [90]	402474	402475
	3.54 [90]	3.94 [100]	402476	402477
	3.94 [100]	4.33 [110]	402478	402479
118.11 [3000]	4.33 [110]	4.72 [120]	402480	402481
	2.36 [60]	3.15 [80]	402482	402483
	3.15 [80]	3.94 [100]	402484	402485
	3.94 [100]	4.72 [120]	402486	402487
	4.72 [120]	5.51 [140]	402488	402489

Note: Items are equipped with seal and connecting hardware on deeper end.

Corner unit

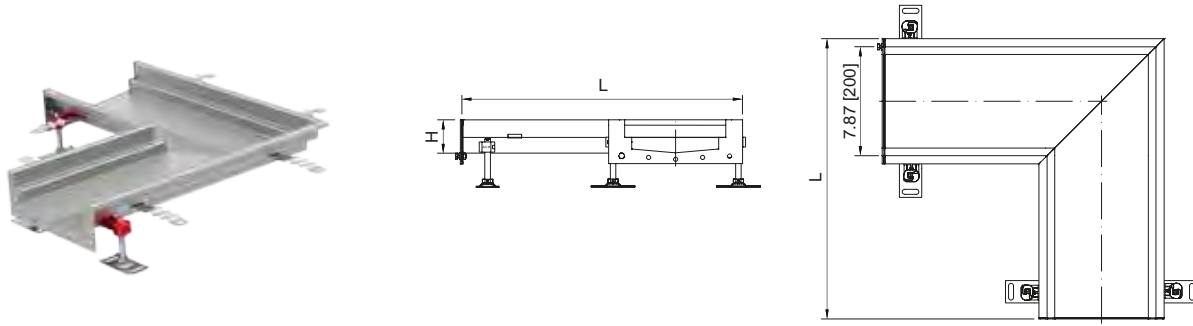

L in [mm]	Dimensions		Part number	
	H in [mm]	AISI 304	AISI 316L	
20.28 [515]	2.36 [60]	401921	401922	
	3.15 [80]	402490	402491	
	3.94 [100]	402492	402493	

Note: Items are equipped with seal and connecting hardware on one end.

Branch unit

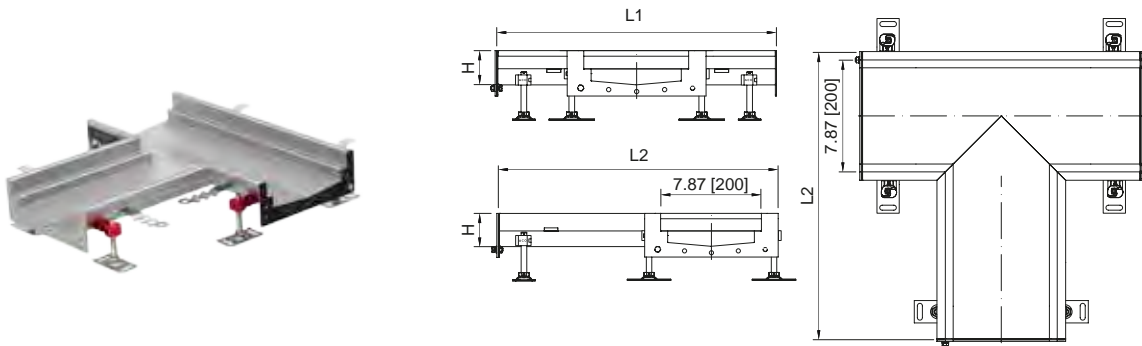

L1 in [mm]	Dimensions		Part number	
	L2 in [mm]	H in [mm]	AISI 304	AISI 316L
19.69 [500]	20.28 [515]	2.36 [60]	401933	401934
		3.15 [80]	402494	402495
		3.94 [100]	402496	402497

Note: Items are equipped with seal and connecting hardware on one end.

End outlet

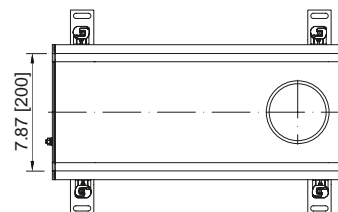
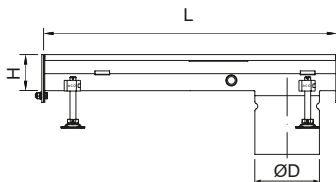

Dimensions		Floor drain	Outlet diameter ØD in [mm]	Part number	
L in [mm]	H in [mm]			AISI 304	AISI 316L
19.69 [500]	2.36 [60]	ACO 10" Hygienic Floor Drain	5.59 [142]	409900	409908
	2.76 [70]			409901	409909
	3.15 [80]			409902	409910
	3.54 [90]			409903	409911
	3.94 [100]			409904	409912
	4.33 [110]			409905	409913
	4.72 [120]			409906	409914
	5.51 [140]	409907	409915		
	3.15 [80]	ACO 12" Hygienic Floor Drain	6" Sch 10	445417	445423
	3.54 [90]			445418	445424
	3.94 [100]			445419	445425
	4.33 [110]			445420	445426
	4.72 [120]			445421	445427
	5.51 [140]			445422	445428

Note: Items are without seal and connecting hardware.

End outlet

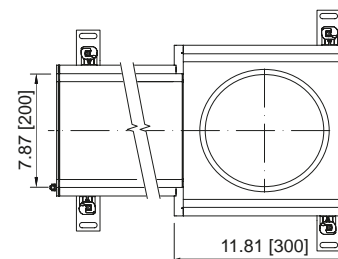
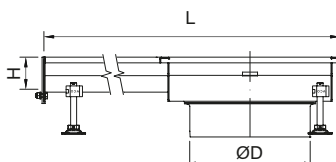

Dimensions		Floor drain	Outlet diameter ØD in [mm]	Part number	
L in [mm]	H in [mm]			AISI 304	AISI 316L
30.91 [785]	2.36 [60]	ACO 12" Hygienic Floor Drain	7.87 [200]	414259	414267
	2.76 [70]			414260	414268
	3.15 [80]			414261	414269
	3.54 [90]			414262	414270
	3.94 [100]			414263	414271
	4.33 [110]			414264	414272
	4.72 [120]			414265	414273
	5.51 [140]			414266	414274

Note: Items are without seal and connecting hardware.

Center outlet

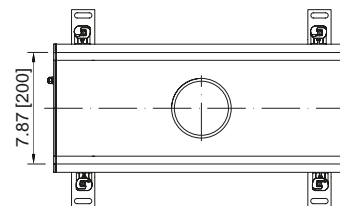
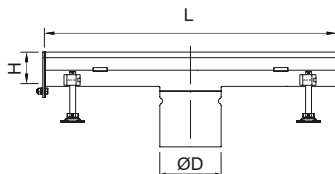

Dimensions		Floor drain	Outlet diameter ØD in [mm]	Part number	
L in [mm]	H in [mm]			AISI 304	AISI 316L
19.69 [500]	2.36 [60]	ACO 10" Hygienic Floor Drain	5.59 [142]	409916	409924
	2.76 [70]			409917	409925
	3.15 [80]			409918	409926
	3.54 [90]			409919	409927
	3.94 [100]			409920	409928
	4.33 [110]			409921	409929
	4.72 [120]			409922	409930
	5.51 [140]			409923	409931
	3.15 [80]			ACO 12" Hygienic Floor Drain	6" Sch 10
	3.54 [90]	445430	445436		
	3.94 [100]	445431	445437		
	4.33 [110]	445432	445438		
	4.72 [120]	445433	445439		
	5.51 [140]	445434	445440		

Note: Items are without seal and connecting hardware.

Center outlet

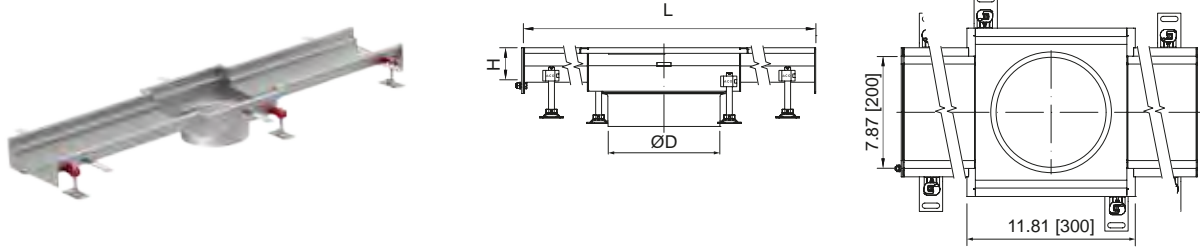

Dimensions		Floor Drain	Outlet diameter ØD in [mm]	Part number	
L in [mm]	H in [mm]			AISI 304	AISI 316L
50 [1270]	2.36 [60]	ACO 12" Hygienic Floor Drain	7.87 [200]	414243	414251
	2.76 [70]			414244	414252
	3.15 [80]			414245	414253
	3.54 [90]			414246	414254
	3.94 [100]			414247	414255
	4.33 [110]			414248	414256
	4.72 [120]			414249	414257
	5.51 [140]			414250	414258

Note: Items are without seal and connecting hardware.

End plate

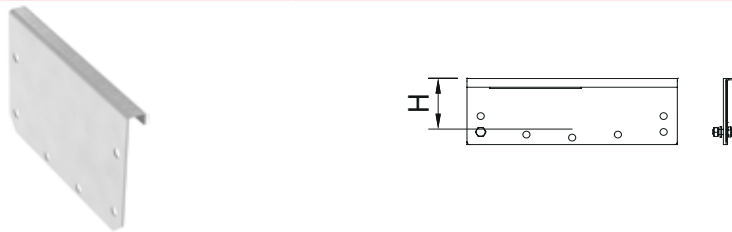

Dimensions	Part number	
H in [mm]	AISI 304	AISI 316L
2.17 [55]	402683	402684
2.36 [60]	402028	402029
2.76 [70]	402030	402031
3.15 [80]	402514	402515
3.54 [90]	402032	402033
3.94 [100]	402516	402517
4.33 [110]	402518	402519
4.72 [120]	402036	402037
5.51 [140]	402520	402521

Note: Items are equipped with seal and connecting hardware.

End plate with 2" [50 mm] outlet

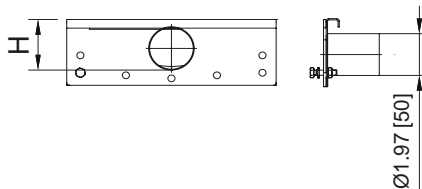

Dimensions H in [mm]	Part number	
	AISI 304	AISI 316L
3.94 [100]	402024	402025
4.33 [110]	402020	402021
4.72 [120]	402022	402023
5.51 [140]	401999	402000

Note: Items are equipped with seal and connecting hardware.

Rubber gasket

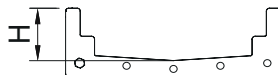

Dimensions H in [mm]	Material	Part number
2.36 [60]	NBR <i>acrylonitrile butadiene rubber</i>	413593
2.76 [70]		413594
3.15 [80]		413595
3.54 [90]		413596
3.94 [100]		413597
4.33 [110]		413598
4.72 [120]		413599
5.51 [140]		413600

Note: Items include seal and connecting hardware.

ACO Modular Channel Grates for ACO Modular 200

Grates for ACO Modular 200

Product information

- Fully tested and classified to EN 1433
- Available in AISI 304 or AISI 316L grades of stainless steel
- Special length 11.81" [300 mm] for branches and corner units
- Slip resistant grates available for added user safety
- Load class A 15, B 125 and C 250 options available
- Full pickle passivated

ACO Mesh Grate

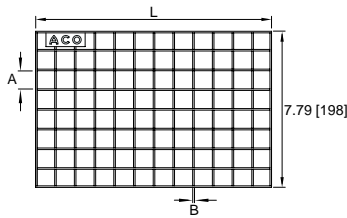

Length L in [mm]	Load class	Slip resistant	Slot size in [mm]		Material	Part number
			A	B		
11.81 [300]	A 15	Yes	0.91 [23]	0.08 [2]	AISI 304	414140
					AISI 316L	414190
19.69 [500]					AISI 304	92200
					AISI 316L	92250
39.37 [1000]					AISI 304	92201
					AISI 316L	92251

ACO Multi-slot 5 Grate

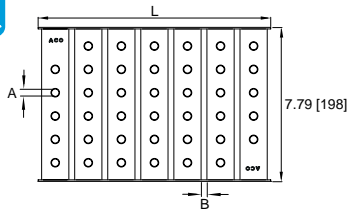

Length L in [mm]	Load class	Slip resistant	Slot size in [mm]		Material	Part number
			A	B		
11.81 [300]	A 15	No	0.37 [9.5]	0.30 [7.5]	AISI 304	414145
					AISI 316L	414195
19.69 [500]					AISI 304	409292
					AISI 316L	409293
39.37 [1000]			0.24 [6]	0.20 [5]	AISI 304	409288
					AISI 316L	409289
19.69 [500]	B 125	Yes			0.26 [6.5]	AISI 304
			AISI 316L	409297		
39.37 [1000]			AISI 304	409240		
					AISI 316L	409241

ACO Hygienic Ladder Grate

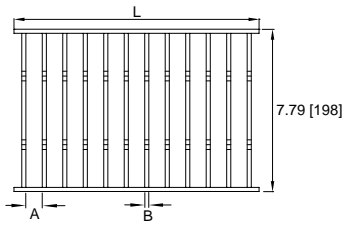

Length L in [mm]	Load class	Slip resistant	Slot size in [mm]		Material	Part number	
			A	B			
11.81 [300]	C 250	Yes	0.79 [20]	0.20 [5]	AISI 304	414142	
					AISI 316L	414192	
19.69 [500]						AISI 304	92214
						AISI 316L	92264
39.37 [1000]			0.78 [19.7]		AISI 304	92215	
					AISI 316L	92265	

Accessories for ACO Modular 200

	Description	Used with	Material	Part number
	Silt basket ■ Stainless steel	ACO Modular 200 with 5.59 [142] outlet	AISI 304	408202
			AISI 316L	408212
		ACO Modular 200 with 5.59 [142] outlet (<i>deeper basket</i>)	AISI 304	445234
			AISI 316L	445235
		ACO Modular 200 with 7.87 [200] outlet	AISI 304	408222
			AISI 316L	408232

ACO Modular Channel - Semi-standard products

Product information

Semi-standard products provide an easy and fast way to get a slot or trench drain of a special length to complete a linear drainage project from standard products. Simply specify the length you need.

How to specify semi-standard products:

Specify the part number from which the semi-standard product will be produced.

How it works:

The semi-standard product is produced from a standard product (neutral invert and sloping invert channels only) which is shortened according to the customer's need. The shortened product is then equipped with flange and sealing materials to fit the channel in the drainage project. A grate of the same length is also produced.

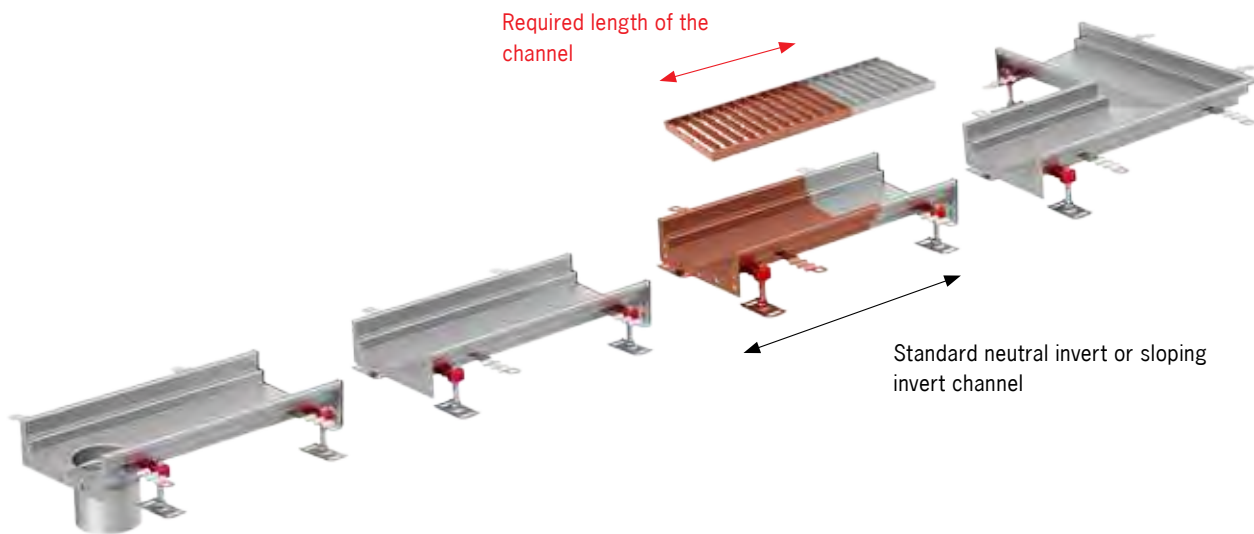

- Specify the required length of the product (start at the deeper end of channel if a channel with slope is used).

